

# FAGERHULT

SE - 566 80 Habo

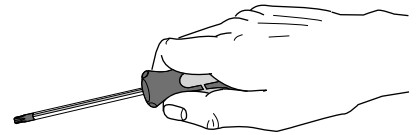

## GLOBIA

Ø 300-400

Ø 250-300

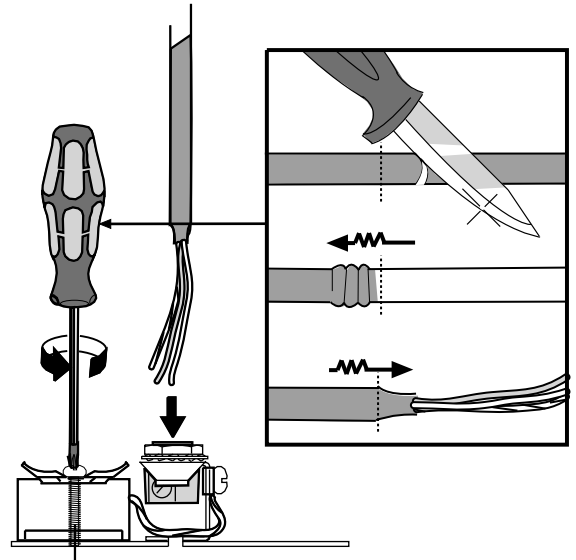
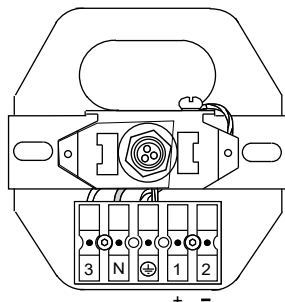
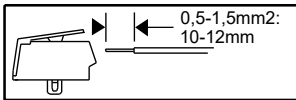
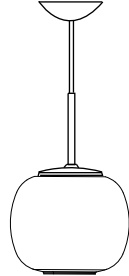
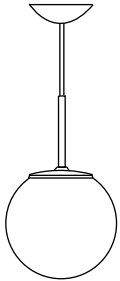

STANDARD	DIGITAL DIM	SWITCH DIM
	→ DALI	
	→ DALI	

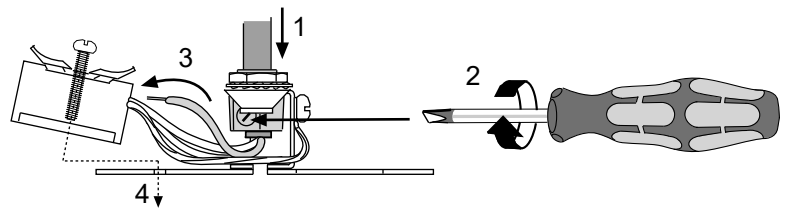

Ø 450

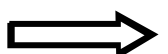
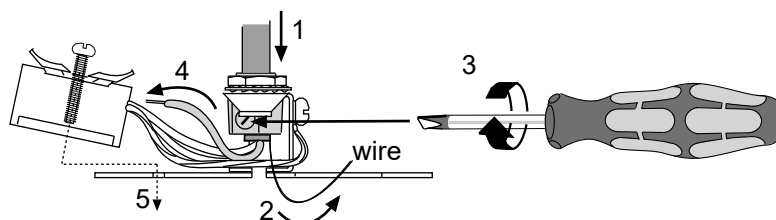
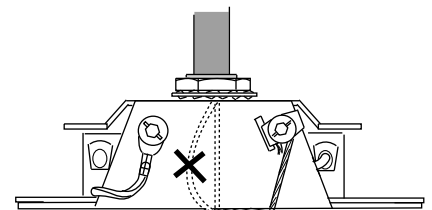
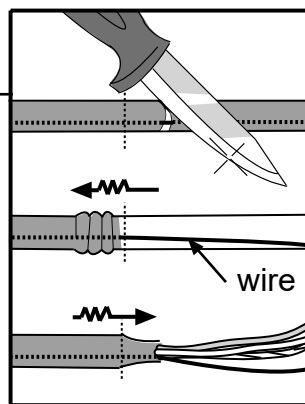
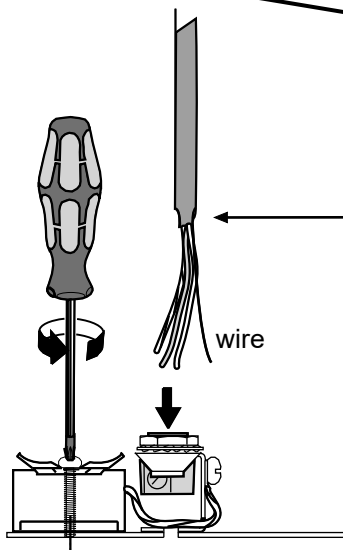
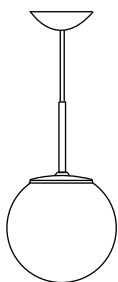

# FAGERHULT

SE - 566 80 Habo

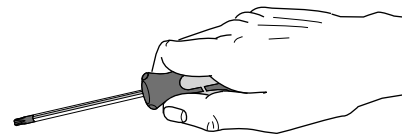

## GLOBIA

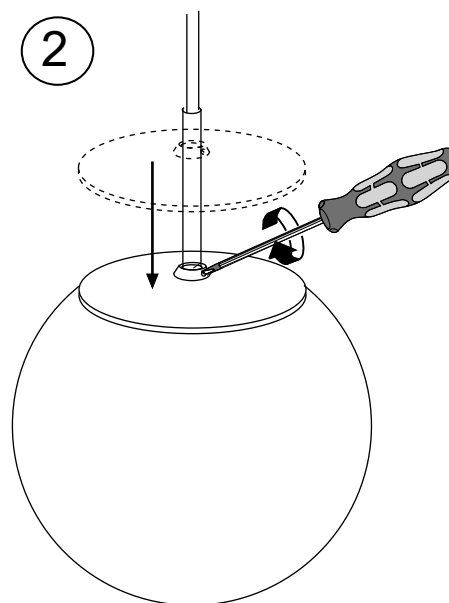
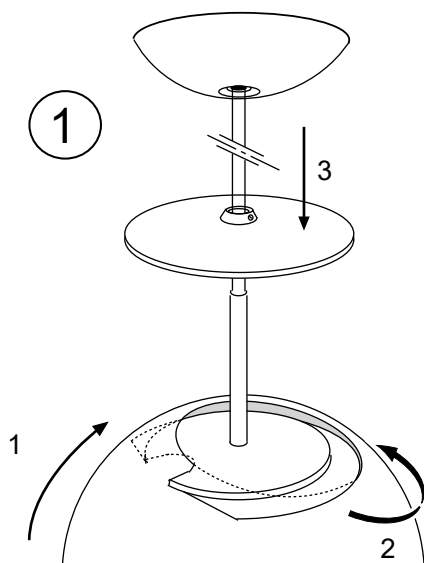
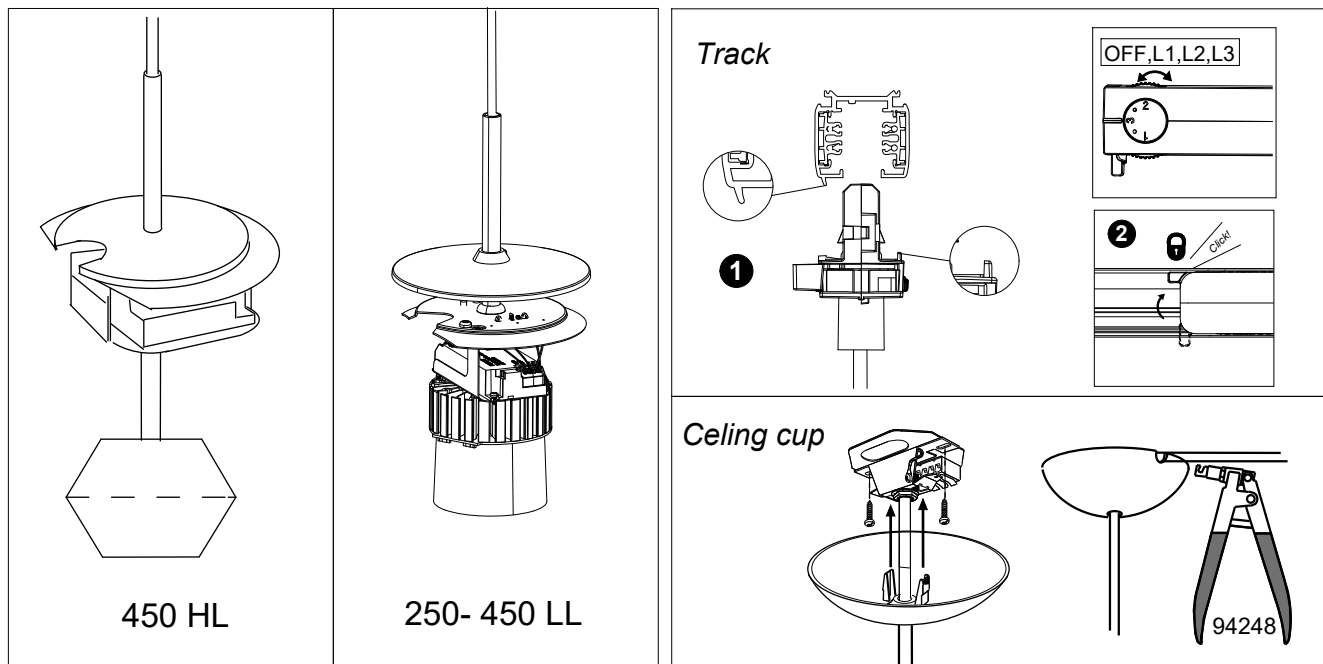

**(S)** Ljuskälla och drivdon ska enbart bytas ut av tillverkaren eller dess utsedda person.  
**(GB)** The light source and control gear shall only be replaced by the manufacturer or its designated person.

DA-	⊕	<b>(S)</b> Grundläggande isolering mellan nät och styr ledning.
DA+		
N	⊖	<b>(GB)</b> Basic insulation between mains and control wiring.
L	⊖	

**(S)** Observera gällande hanteringsföreskrifter mot elektrostatisk urladdning.  
**(GB)** Notice management regulations against electrostatic discharge.

**(S)** Det är lämpligt att denna information överlämnas till användaren av anläggningen. **(GB)** It is appropriate that this information is passed on to the users of the installation.

Manufactured by Fagerhult  
 For UK market importer Fagerhult UK  
 33-34 Dolben Street, London, SE1 0UQ

